



## **INTRUDER SCENARIO**

As the students arrived at school on the first day after spring break, a woman in her middle 20s is noticed entering through the main entrance. Because the teachers knew that she is the spouse of the English teacher, no one questioned her as she entered the building. The woman, however, did not report to the office but went to her husband's classroom with the students instead.

When the woman arrived in the classroom, she pulled out a 9mm hand gun and began screaming at her husband. (Her husband had told her the evening before that he was going to file for divorce and request custody of their child.) Immediately, the teacher shouted for the students to hit the deck.

Upon hearing the commotion, a teacher in a nearby room called the office. The schools emergency plan was immediately activated.

---

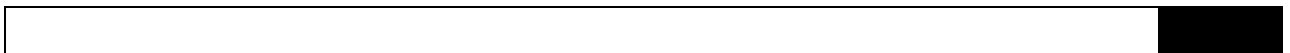



# INTRUDER SCENARIO (CONTINUED)

School

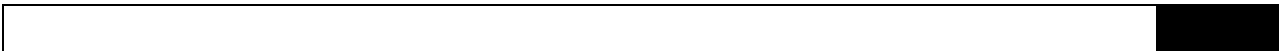
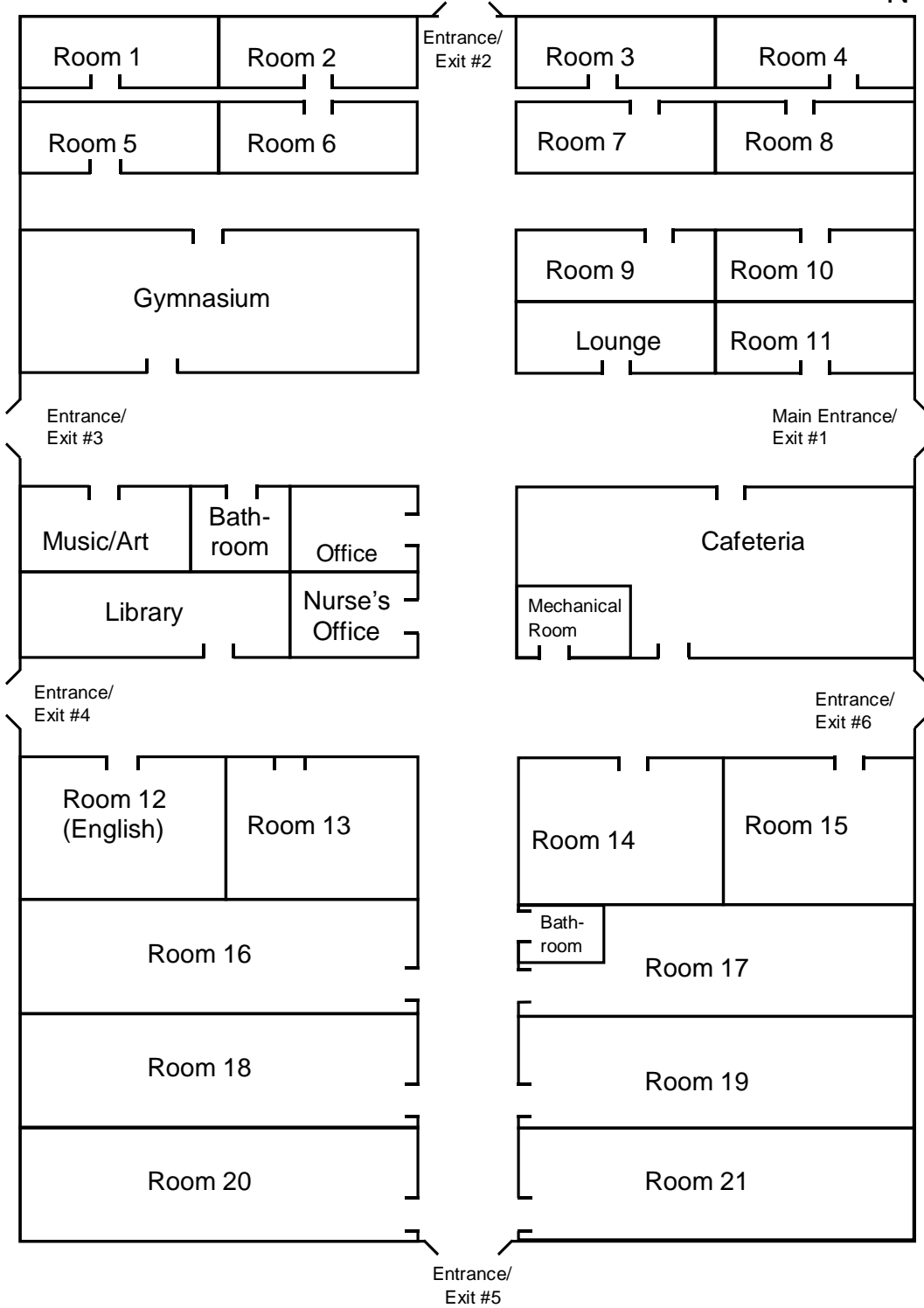



# INTRUDER SCENARIO (CONTINUED)

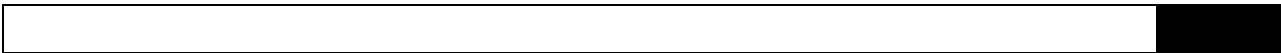
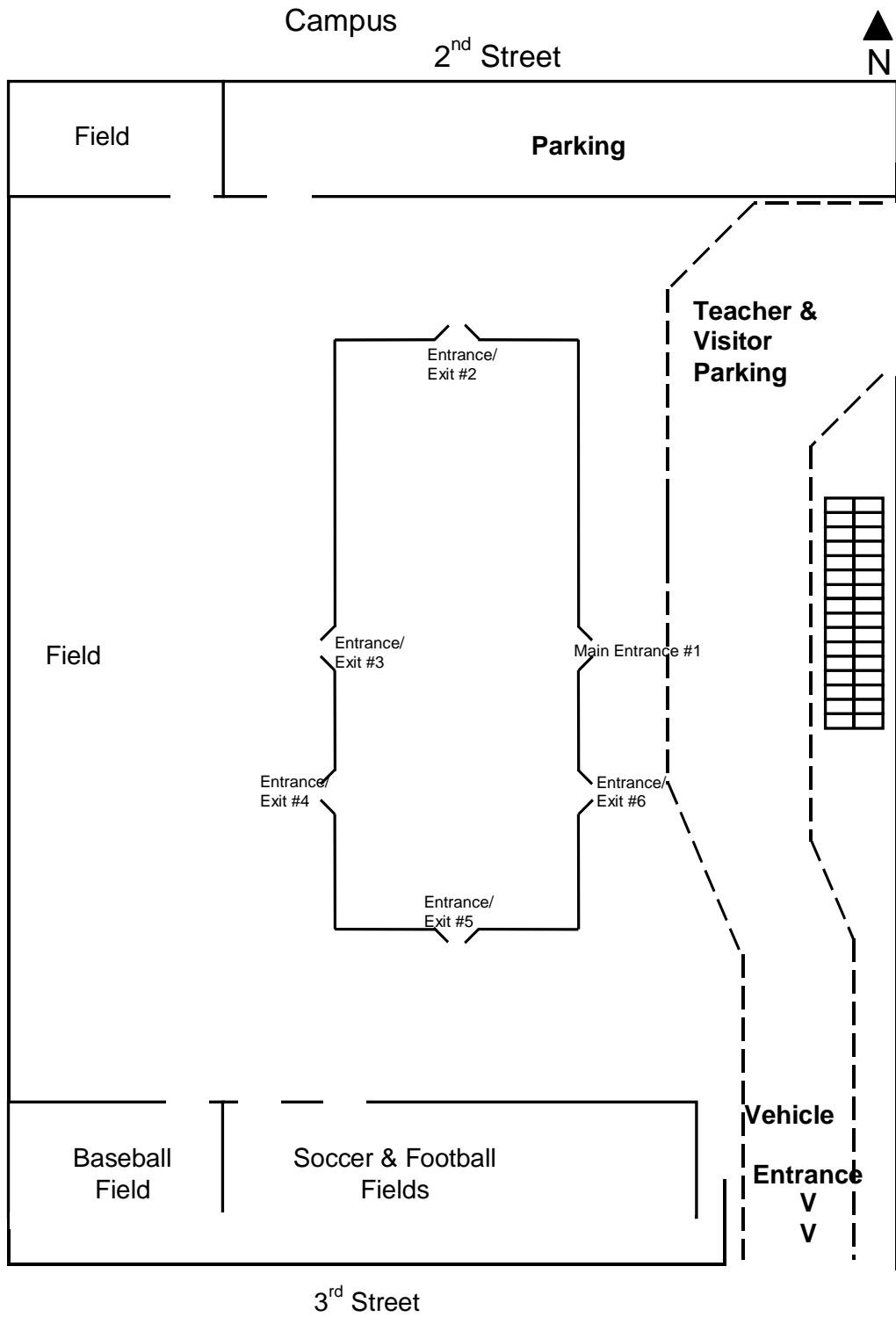



## INTRUDER SCENARIO (CONTINUED)

### Scenario Questions

1. To respond to this incident, you will establish your management structure using the ICS model. Draw your initial emergency organization, including the personnel assigned to each position (by title), in the space provided below.
2. Where will you establish your Command Post for this Incident?
3. What will you do first? Why?
4. What is your first concern in this situation?
5. What special concerns should you have?
6. For what contingencies must you plan?

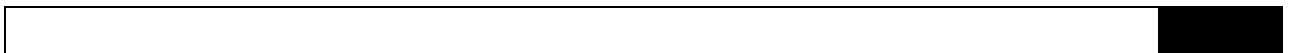



## INTRUDER SCENARIO UPDATE #1

The police have been called and are on their way. According to a teacher in an adjacent classroom, a male teacher who went to the classroom in an attempt to calm the shooter has also been taken hostage. The woman is highly agitated and is screaming at her husband and his students.

A custodian has told your secretary that he is going to sneak down the hallway to see if he can gather more information about what's going on in the classroom.

---

### Update #1 Questions:

1. Does this information change your planning? If so, how?
2. What should you do about the custodian?
3. Will you evacuate some or all of the school?
4. For what contingencies must you plan now?
5. What will you tell parents? How will you notify them?

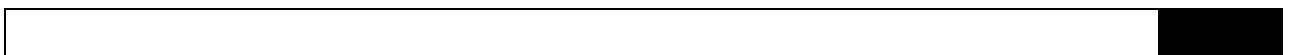





**INTRUDER SCENARIO UPDATE #2 (CONTINUED)**

4. What does the fact that the male teacher tried to intervene tell you about your emergency plan?

5. For what long-range processes must you plan?

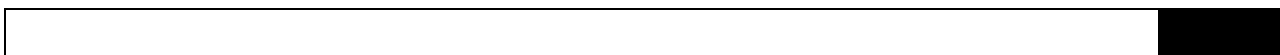



## INTRUDER SCENARIO UPDATE #3

It is now approximately 1½ hours since the incident started. Through the efforts of the police department's hostage negotiator, the shooter has surrendered without further violence. Police are escorting her to a police vehicle.

The media picked up on the incident and began interrupting regularly scheduled programming about 30 minutes ago. Since that time, the telephone at the school has been ringing constantly as parents try to find out about their children. Parents are starting to arrive and are upset that the police will not allow them past the barrier to talk to school personnel and find their children.

---

### Update #3 Questions:

1. What can you do to assist the police in addressing the parents' concerns?
2. How will you handle the media?
3. What insights has participating in this exercise provided you about your school's or district's state of readiness for an emergency situation involving a terrorist? What revisions would you recommend to your emergency plan as a result?

